

3

**No Bridge. No Toll.**  
Keep your health care local.

4

**Your ER**  
Skyline partners for stronger ER care.

8

**Getting Donna Back on Her Feet**  
Grateful patient shares her experience at Skyline.

**Rudy & Keren Dierickx**  
Cultivate Columbia Honorees

# GIVING HEALTH

# SKYLINE NEWS



Dear Friends,

At Skyline, we take a hands-on approach to patient care. We recognize the importance of teamwork and believe great results can be achieved when we work together.

#### **What makes a health care team successful?**

One of the most important aspects of teamwork is focus, and we are focused on you. Skyline's physicians and staff have aligned themselves with our mission and vision, and have one goal in mind: to make

Skyline the best place for you and your family to receive care.

We continue to seek ways to enrich our services and extend support to the growing communities we serve. Recent examples include:

#### **Skyline Medical Clinic**

Skyline Medical Clinic opened in October, adding Family Medicine, as well as Ear, Nose and Throat care to our already established services. Our goal is to provide additional health care options for patients, and make it easier for you and your family to establish lifelong care. We know how important it is to have health care available close to home, and hope you'll decide – when referred for services – to keep your care local to our community. This can be done by using services provided by Skyline Hospital rather than driving to another city or state to receive care. (see page 5)

#### **Emergency Department Physicians**

In our constant effort to improve the patient experience and to provide the highest quality of care, we have partnered with Northwest Emergency Solutions, an emergency physician group, to staff our Emergency Department. This change took place on November 1 and we are thrilled to have the new emergency medicine physicians as a part of the Skyline team. (see page 4)

#### **Skyline Expansion and Renovation**

The Skyline Foundation, which is the fundraising arm of the hospital, recently launched a \$2M campaign to expand and renovate our Emergency Department, reconfigure the main entrance, and replace our boilers and HVAC system. We are not only excited to observe the expansion of our services, but know it's important to improve our facilities in order to support the health and wellness needs of our community. (see page 6-7)

As you can see, we are dedicated to making our health care organization the best it can be. In all we do, our focus remains on our patients. We are grateful for the trust you place in us and for choosing Skyline Hospital as your health care provider of choice.

Robb Kimmes

Chief Executive Officer  
Skyline Hospital

#### **Skyline Hospital**

[www.skylinehospital.com](http://www.skylinehospital.com)

#### **Administration**

Robb Kimmes, chief executive officer

Les Dewey, chairman, hospital board of trustees

Russell Smith, M.D., chief of staff

#### **Skyline Hospital**

211 Skyline Drive, White Salmon, WA 98672

509-493-1101 [www.skylinehospital.com](http://www.skylinehospital.com)

A critical access hospital providing acute, emergency, trauma and transitional care.

Other services include laboratory, radiology, cardiopulmonary, neurology, podiatry, ear, nose & throat and surgical services.

#### **Skyline Medical Clinic**

211 Skyline Drive, White Salmon, WA 98672

509-637-2810 [www.skylinehospital.com](http://www.skylinehospital.com)

An outpatient clinic offering primary and specialty care.

#### **Family Medicine**

Erica Didier, M.D.

Jenna Newcomb, PA-C

509-637-2810

#### **Surgical Services**

Seth Lambert, D.O.

509-637-2810

#### **Ear, Nose and Throat**

Mendy Maccabee, M.D.

509-637-2810

#### **Neurology & Pain Management**

Karleen Schwarztrauber, M.D.

509-637-2810

#### **Podiatry Clinic**

Ankle/Foot Physicians and Surgeons

360-977-7815 [www.ankleandfootphysicians.com](http://www.ankleandfootphysicians.com)

#### **Skyline Physical Therapy**

253 Rhine Village Drive, White Salmon, WA 98672

509-493-5119

An outpatient physical therapy clinic offering a variety of rehabilitation services and programs.

#### **Skyline Foundation**

211 Skyline Drive, White Salmon, WA 98672

509-637-2602 [www.skylinefoundation.org](http://www.skylinefoundation.org)

Skyline Foundation is a 501(c)(3) non-profit organization raising funds to support Skyline's services and programs.



# NO BRIDGE ... NO TOLL ... JUST QUALITY HEALTH CARE

## GET YOUR HEALTH CARE WHERE YOUR LIVES

The friendly, kind staff at Skyline work diligently to deliver the very best service and highest quality of care to you and your family – at every stage of life.

By taking advantage of what Skyline – your local hospital – offers, you not only strengthen the local economy, but experience what you can only find in our rural community.

- Patient-centered high quality care – close to home
- Responsive and respectful approaches to your unique needs
- Individualized and personal attention
- Genuine care for you and your loved ones
- Compassion and support you and your family deserve
- Clinicians and staff who take the time to know you
- Authentic and engaging relationships with providers
- Consistent and grounded care in a changing health care landscape



### WHY DRIVE DOWN THE GORGE OR ACROSS THE RIVER WHEN YOU CAN GET THE HEALTH CARE SERVICES YOU NEED LOCALLY FROM A HOSPITAL THAT IS INVESTED IN ITS COMMUNITY?

Skyline gives back to the people they serve, supporting our local economy and improving the health of our population. You think about shopping local and eating local. Keep your health care local too.

### AS A PATIENT, WHAT PART CAN I PLAY?

It's simple. When being referred by your primary care provider for services such as radiology, lab, surgery, infusion or a specialty physician – ask to go to Skyline and receive your health care where you live.

### WHY IS THIS IMPORTANT?

By choosing Skyline for your services, you not only enjoy a more distinctive and personal experience, you're investing in your community. What stays local, grows local by:

- Creating and sustaining jobs
- Strengthening the local economy by keeping money in the community
- Creating a healthier local environment
- Giving back to your community
- Reducing environmental impacts

**YOU HAVE A CHOICE OF WHERE YOU  
RECEIVE HEALTH CARE – CHOOSE SKYLINE!**





From left to right:  
Mahinda Ratnayake, M.D.;  
Gus Faller, M.D.; and  
Russell Smith M.D.

# Your **ER**

## Bett**ER** · Fast**ER** · Strong**ER**

**W**hen you need help the most, we're here for you. Whether you've had an accident or are seriously ill, Skyline Hospital's Emergency Department is ready for you 24 hours a day, 7 days a week.

In Skyline's continued effort to provide the best and highest-quality of care, it has partnered with Northwest Emergency Solutions to manage and help staff its Emergency Department. This change brings emergency medicine board certified physicians Mahinda Ratnayake, M.D.; Gus Faller, M.D.; and Andy Miller, M.D.; to Skyline's Emergency Department. This group combined with Skyline's clinicians and services, provide the most comprehensive emergency care available in this area.

"Providing better, faster and stronger care with the right resources is our team's primary focus," said Robb Kimmes, Skyline Hospital chief executive officer. "Having the expertise of these physicians – who only specialize in emergency medicine – will improve patient outcomes, reduce readmissions and enhance the patient experience.

Every Emergency Department can be a challenging and stressful place to work, and the Skyline Hospital Emergency Department is no exception. But this highly skilled team of board certified physicians, registered nurses, advanced mid-level providers and other specially trained staff meet the challenges and exceed expectations every day. The result is a community resource patients have come to rely on for their health and well-being.

"Like any work environment, people make the difference and the dedicated Emergency Department staff at Skyline are truly amazing," continued Kimmes. "Compassionate and extremely competent, their patient dedication is second to none."

### Skyline Hospital's Emergency Department Physicians

Russell Smith, M.D.  
Mahinda Ratnayake, M.D.  
Gus Faller, M.D.  
Andy Miller, M.D.  
Kathleen Myers, M.D.  
Samir Bishai, M.D.

Chris Van Tilburg, M.D.  
Frank Rinella, D.O.  
Eric Holden, PA-C  
Vee Yoong, PA-C  
Eric Stroud, PA-C  
Jenna Newcomb, PA-C

# SKYLINE MEDICAL CLINIC

## Enjoy the BEST HEALTH possible

### WE PUT PATIENTS FIRST

At Skyline Medical Clinic, we value patients first. We are committed to providing patient-centered care and outstanding service, delivered with respect and compassion. We understand health care can be complicated, and it hasn't always been easy for patients to access care or navigate their health experience. This is why we are in the midst of transforming your experience – striving to provide exceptional care that is simply delivered.

### SIMPLE AND CONVENIENT HEALTH CARE

An outstanding and memorable health care experience – we believe – begins before you ever set foot in our clinic, and includes the care you receive without ever visiting us. We expect you to be able to easily obtain the information and resources you need, and to make appointments in ways that respect your time and ensure access to quality care providers. If you need follow-up care with a different provider, we're committed to making those arrangements simple and convenient too.

### YOUR PARTNER IN HEALTH

When you're in our care you deserve to be treated with dignity, to be provided with a full understanding of your condition and your treatment, to know who is providing your care and how long it will take.

When your time with us is complete we're determined to partner with you by providing continued access to information so you can succeed in your journey toward optimal health.

### CONTINUOUS IMPROVEMENT

We will continue to look for ways to improve your experience at Skyline Medical Clinic. Each member of our staff is dedicated to providing the highest quality of care and patient safety teamed with the latest medical technology. We want to hear from our patients and encourage you to contact us if you have concerns or questions regarding your care.

Thank you for letting us make a difference in your experience through excellent patient care.

### OUR CLINIC SERVICES INCLUDE

Family Medicine  
Ericka Didier, M.D.  
Jenna Newcomb, PA-C

Ear, Nose & Throat  
Mendy Maccabee, M.D.

General Surgery  
Seth Lambert, D.O.

Neurology & Pain Management  
Kari Schwarztrauber, M.D.

Podiatry – Ankle/Foot Physicians and Surgeons

- Accepting new patients
- Serving adults and children
- Accepting private insurance, Medicaid and Medicare
- Offering discounted pricing for uninsured patients
- Conveniently located on Skyline Campus
- Same day & evening appointments (for some services)
- Walk-in patients welcome

*To schedule an appointment, call 509-637-2810.*



# Expanding on excellence

## CAPITAL CAMPAIGN

SKYLINE HOSPITAL'S STRATEGIC INITIATIVE TO PROVIDE QUALITY HEALTH CARE TODAY, TOMORROW AND FOR FUTURE GENERATIONS

### OUR GROWING COMMUNITY

Skyline Hospital's vision is to be the local health care provider of choice. To do so, we must be responsive to the changing needs of the community. In the last 20 years, technology has advanced at a rapid pace and the population of our community has grown significantly. As industries and families continue to realize the benefits of residing on the Gorge, our population will continue to expand. We are committed to growing together.

### EXPANDING ON EXCELLENCE

Through the Expanding on Excellence capital campaign, Skyline Hospital will provide Gorge residents with ever-greater levels of compassionate care. Key support from individuals, businesses, foundations and public funders will be leveraged to achieve our strategic vision of continuing to provide exceptional high-quality care today, tomorrow and for future generations. This initiative is designed to transform the patient's health care experience.



## OUR FOCUS: QUALITY CARE YOU CAN COUNT ON

Skyline Hospital is not only excited to observe the expansion of our services, but knows it's important to grow in order to support the health care and wellness needs of our residents.

The expansion of the Emergency Department, reconfiguration of the main lobby and the addition of dedicated public space are key to providing the best quality care for our patients.

## HOW OUR PATIENTS AND COMMUNITY WILL BENEFIT

### Expanded and renovated Emergency Department

- Double the current square footage
- Addition of triage room
- Increased privacy for patients
- Dedicated visitor waiting area
- Enhanced technology and efficiencies
- Improved patient flow and discharge

### New Main entrance, waiting area and public space

- Central patient registration
- Separate patient and public spaces for confidentiality and privacy
- Easier navigation for patients and visitors
- Dedicated public space to serve patients, families and community members

### Updated Boilers and HVAC system

- Improved comfort for patients, families, visitors and employees

### Other features

- Enhanced campus will attract additional specialty physicians for our community
- Improved campus orientation

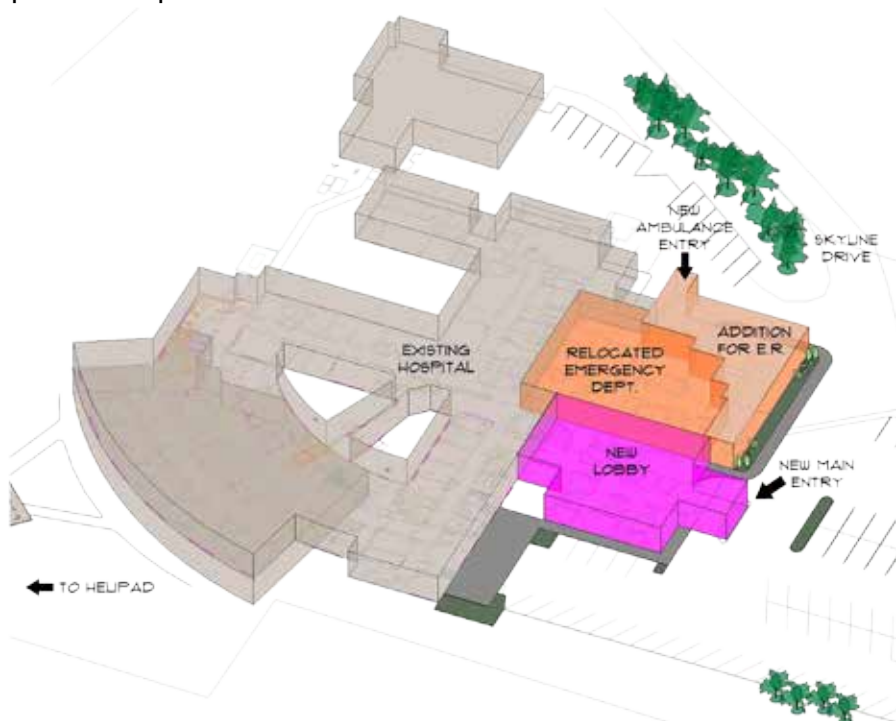

## Our Campaign Goal is: \$2M

### LEADING THE WAY

The Expanding on Excellence capital campaign is lead by community volunteers who are dedicated to seeing this project through to fruition. These individuals give their time, but each one has given a meaningful gift to the campaign - we hope you will consider one as well.

Margaret Walker, *Honorary Chair*  
Bob Weisfield, *Acting Chair*  
Jonathan Blake  
Scott Clements  
Lorrie Knowles  
Ricky Knowles  
Sue Massart  
Janet McCutcheon  
Commissioner Dave Sauter

### PROJECT SUPPORT

From the initial feasibility study through the campaign launch on July 1, 2017, the Expanding on Excellence capital campaign has benefited from tremendous community support. As we continually work to improve the health of our community by creating a more coordinated, effective and sustainable health care delivery, we rely on people - like you - to help us achieve our goals. We thank you in advance for your generosity.





# GETTING DONNA BACK ON HER FEET



**W**hen White Salmon Council Woman, Donna Heimke stumbled while exiting her vehicle outside the courthouse, she fell forward, landing on her back. “I was hopeful everything was okay, but I soon realized something was very wrong,” said Heimke.

As her pain increased and she was no longer able to stand, she was transferred by ambulance to Skyline Hospital.

“During our time in the Emergency Department we received all of the necessary medical procedures, but what impressed us the most was the amount of caring attention given to my wife,” explains Dave Heimke, Donna’s husband.

Heimke’s accident resulted in a broken femur in two places. After having orthopedic surgery and spending three days in acute care, she was transferred to Skyline Hospital’s Transitional Care Program to begin the healing process.

Transitional care is a program which allows smaller, rural hospitals to open up their beds to provide inpatient care to those patients – like Heimke – who no longer qualify for acute care, but who are not quite ready to return home due to needing services such as physical or occupational therapy, wound care and IV or respiratory therapies. Often, it means those

patients can receive the care they need closer to home, and for Heimke – with her established local roots – this was vital.

“It made me feel good to be in my hometown. It took a load off my husband and meant the kids didn’t have to

travel 100 miles to come and see me,” said Heimke. “Everyone was just wonderful. I don’t think I could have received better care anywhere.”

When asked about her care at Skyline, Heimke said, “From the first person who took care of me to the last, each and every one was constantly responsive to my every need. I never felt I was imposing, and things were always done in good cheer and with a smile. Not only was I allowed to have my dog Essi visit, but they went out of their way to set up my bible study group to meet in the activities room so I could keep some semblance of normalcy even while in the hospital. Truly remarkable!

“In addition to regaining my health, I’ve made some wonderful friends,” smiled Heimke. “Skyline is a very valuable asset to our community and we can’t thank the staff enough for the tremendous, high-level care they provided. My stay helped prepare me to return to my everyday life and I am proud to say I went home both physically and emotionally stronger.”

**"It made me feel  
good to be in my  
hometown."**



# IN SUPPORT OF OUR COMMUNITY

Outside its hospital doors, Skyline is helping to build an expansion of health and wellness through our ever-growing family of community partners. Standing with area businesses and community leaders, our message and our mission is spreading throughout our communities and beyond—giving more and more people access to resources for living healthier, happier lives.

## CARING FOR OUR NEIGHBORS

The Skyline Foundation was thrilled to donate \$25,000 – and join our community – to support those families impacted by the Underwood Fruit Company fire. The funds will be used toward health care needs.

“When the request was made to support our neighbors at Underwood Fruit Company, there wasn’t a board member who hesitated,” said Elizabeth Vaivoda, Skyline Foundation executive director. “It’s humbling to be part of an organization that gives back to our communities so freely and believes when we come together we can make a difference. I know I speak for the board, when I say ‘our hearts are full.’”

## KEEPING INSITU HEALTHY!

With the flu season in full force, Insitu leaders wanted to ensure their staff stayed protected. Toward this health effort, Skyline Medical Clinic recently partnered with Insitu providing an on-site flu shot clinic. More than 130 Insitu staff members took advantage of the clinic’s convenience and received the vaccination – preparing them for the influenza season.

“An onsite flu clinic is a workplace solution designed to make vaccination as simple as possible,” said Debi Budnick, Skyline’s community wellness coordinator. “Getting a vaccine early in the flu season is the easiest, most effective way to stay flu-free. Skyline was happy to offer this service and looks forward to partnering with Insitu for future health care needs.”

To learn more about Skyline’s community wellness services, call 509-637-2601.



*Leslie Naramore, Washington Gorge Action Programs executive director, accepts Skyline Foundation's \$25,000 donation from Elizabeth Vaivoda, Skyline Foundation executive director. This donation, which is distributed through WGAP, will assist those families affected by the Underwood Fruit Company Fire.*





**A**ll of us at Skyline Hospital truly believe in our mission of providing an exceptional level of health and well-being in our community. The Skyline Foundation embraces the responsibility of raising the funds to help our hospital fulfill its mission. We celebrate the partnerships that have led to creating stronger and healthier communities.

Because of the generosity of donors – like you – our caring and highly trained physicians, nurses and other health care providers have improved patient experiences, provided essential services, saved lives

and positively impacted the health of our Gorge communities through education and outreach programs.

We hope you'll consider a tax-deductible gift to Skyline Foundation. To make a donation, simply return the enclosed envelope or give electronically by visiting [www.skylinefoundation.org](http://www.skylinefoundation.org).

**THANK YOU** for your generosity, which will support the programs and services that touch our local communities.

## because of you . . .

Assistance to families affected by the Underwood Fruit Company Fire  
**Veggie RX Program** Positive Discipline Parenting Program  
**Breast Health Screenings for the under/uninsured**  
Annual scholarships for students Concussion testing for local high school students  
Dental kits for head start students Training/equipment for emergency medical technicians  
**New computer system for Advance Life Support training**  
**Cardiac monitoring equipment** Art for the Soul Program  
**HUGS (Help us Grow Safely) Program** **Bike Safety/Helmet Program**



**P.O. Box 99  
White Salmon, WA 98672**

[www.skylinehospital.com](http://www.skylinehospital.com)

*Klickitat County Public Hospital District  
No. 2, dba Skyline Hospital, is  
supported in part by tax proceeds.  
Skyline is governed by an elected  
five-member board of commissioners.*

PRSRT STD  
U.S. POSTAGE  
**PAID**  
PORTLAND, OR  
PERMIT NO. 2037

# SAVE THE DATE

## Cultivate Columbia

Honoring Rudy & Keren Dierickx  
March 17, 2018 • 5:30 p.m.

Mark your calendars for Skyline Foundation's annual fundraising gala, Cultivate Columbia.

Guests will experience a delectable meal with local wines and beer, meet local artists, view unique artwork and enjoy a lively auction.

Individual seats are \$85 each or purchase a table of eight for \$700. Reserve your seats now as this popular event sells out quickly.

For information or to reserve your seats contact the foundation office at 509-637-2602 or [elizabethvaivoda@skylinehospital.org](mailto:elizabethvaivoda@skylinehospital.org).



**This year's event will honor  
longtime local residents  
Rudy & Keren Dierickx,  
whose service to our  
communities spans decades.**